



IS-1510 Wireless Electronic Switch

1. Introduction

The series of wireless electronic switch adopts wireless radio frequency control mode. Remote works non-directional, without space constraints. It can be wall and compartment remote control. Hundreds of millions of address codes never repeated. Similar products never string code. It has been widely used in many environments. Such as home, factory, office room, store and so on. It is one of your ideal electronic switch. It classed products as wall switch and hand-held remote controller; it can match with our wireless alarm control panel to use. It is simple design, electric supply input, and similar to most of occasions. Easy installation, beautiful design, it can directly fix in the hole or ceiling. Instead of traditional switch lamps or lights.

2. Specification

Input voltage: 240VAC 50/60HZ

Standby Power: 1W

The maximum load power (one channel): Load <100W Totally <300W

Control mode: Wireless remote and manual control

Remote distance: 30 meters (in the open air)

Suitable to be installed in 86 box (not included)

3. Installation

Note: Must be power off while installation otherwise it will cause mal function.

- 1) To make the shell around toward its outside and tear down the shell.
- 2) Pull up the switch, you will find two screw mounting hole.
- 3) Fine the power line and connect the line as right photo display.
- 4) Put the switch into the wiring box and use two screws to fix.
- 5) Install the surface shell well.

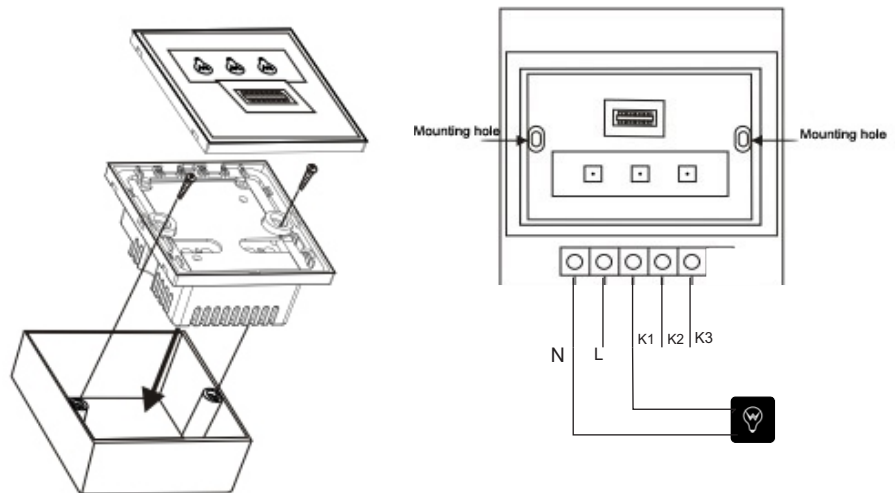

4. Introduce For 3 Channel Operations.

Note : First remove the switch front side touch panel. Black button is in middle of PCB.

1. Touch button operation notice

To touch  all the buttons, respectively control the corresponding switch (red light is on, blue light is off)

2. Enroll to our Server series

E.g. Enroll switch channel 1

First note the three bar code number at back side of switch. Then navigate to server smart home function and create "area" name and inside the specified area name Click "Add Device" and type noted number in the blank box, then click save

3. Enroll to the remote controller.

Make sure 3 lamp led color is blue. Press the black button for 2s, the red and blue light will flash for 1 times respectively 2 times will flash then, within 10s, press any lamp button in the remote controller. After 10s, the switch will exit to enroll, or after the switch enroll into the remote control, press the black button for once, when existing, the blue and red light will flash once. Same switch can be enrolled into 10 remote controllers at max.

4. Delete remote code.

Make sure 3 lamp led color is red .Long press the black button for 8s, the red and blue led light will flash 6 times respectively, then the code of remote is deleted from the switch.

5. Operation for remote controller.

Channel 1: press lamp 1

Channel 2: press lamp 2

Channel 3: press lamp 1 and lamp 2 at the same time.

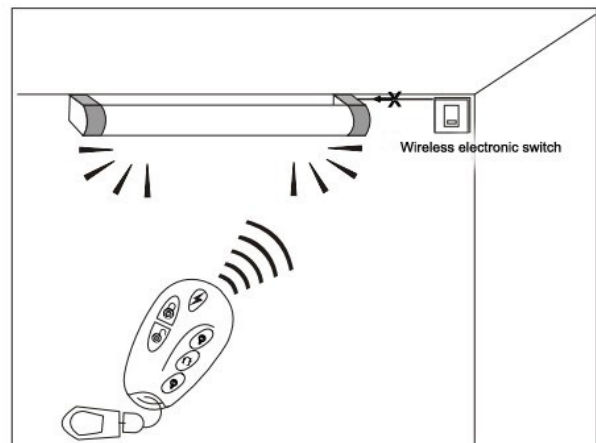
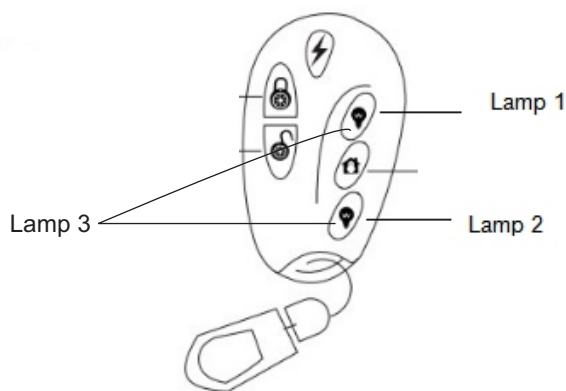

- Note:**
1. Please do not install when electrical power is on.
 2. Please do not install in high humid environment.
 3. Please do not use it beyond the loading